

ATTACHMENT 3
FEMA FIRMS

Cowlitz Timber Trails Association

Section locations, distances, floodplain widths and floodplain areas

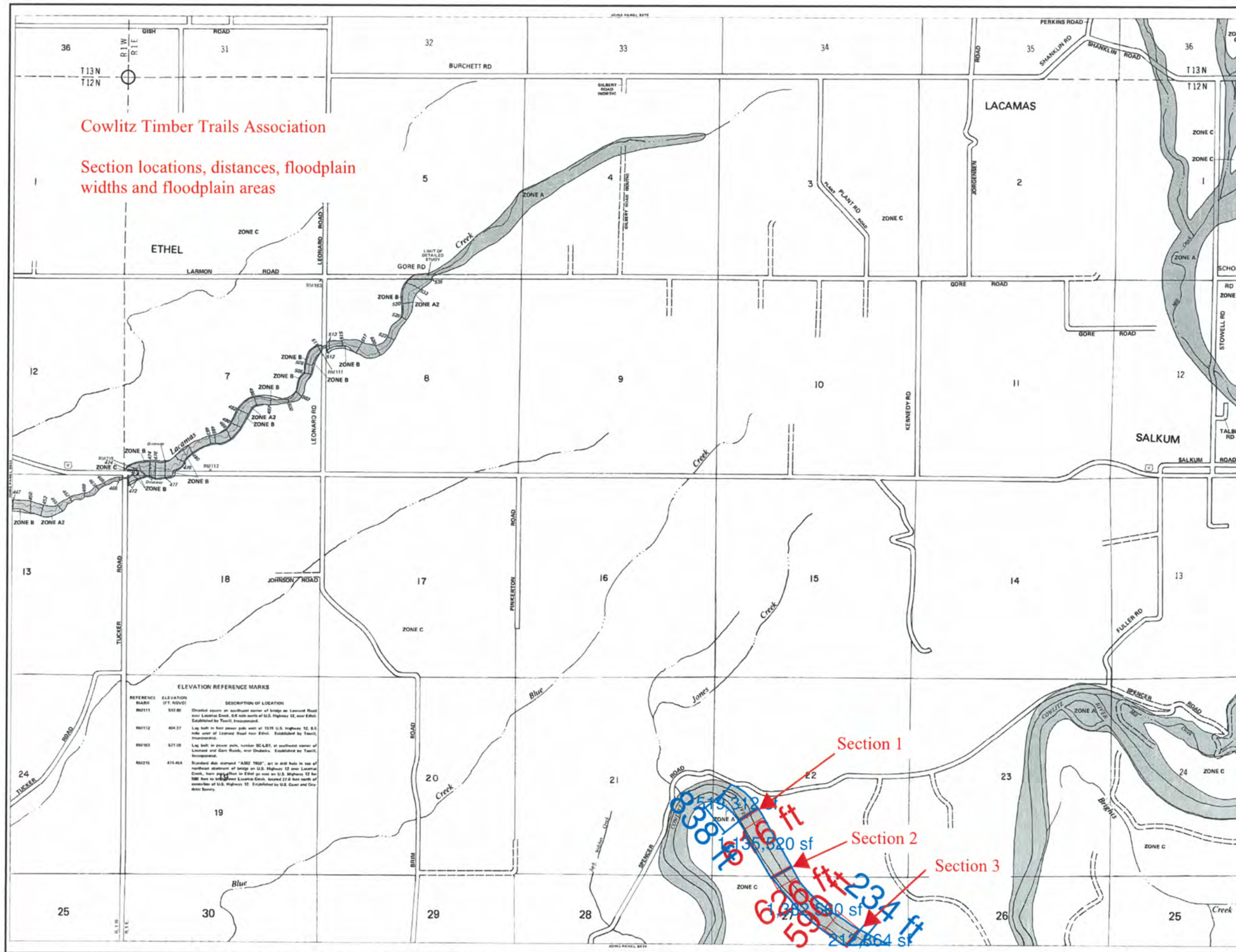

KEY TO MAP

- 300 Year Flood Boundary
- 100 Year Flood Boundary
- Zone Designations
- 500 Year Flood Boundary
- 500 Year Flood Boundary
- Base Flood Elevation Line With Elevation in Feet
- Base Flood Elevation in Feet (See Note 1)
- Base Flood Elevation in Feet (See Note 2)
- Zone D Boundary
- Area Map

EXPLANATION OF ZONE DESIGNATIONS

ZONE A
Area of 100-year flood, base flood elevations and flood hazard factors not determined.

ZONE B
Area of 100-year shallow flooding where depths are between one (1) and three (3) feet; base flood elevations are shown, but no flood hazard factors are determined.

ZONE C
Area of 100-year shallow flooding where depths are between one (1) and three (3) feet; base flood elevations are shown, but no flood hazard factors are determined.

ZONE D
Area of 100-year flood, base flood elevations and flood hazard factors determined.

ZONE E
Area of 100-year flood to be protected by flood protection system under construction; base flood elevations and flood hazard factors not determined.

ZONE F
Area between limits of the 100-year flood and 500-year flood, or other area subject to 500-year flooding with average depths less than one (1) foot or where the contributing drainage area is less than one square mile or area protected by levees from the base flood (subject flooding).

ZONE G
Area of minimum flooding (no shading).

ZONE H
Area of unincorporated, but possible, flood hazards.

ZONE I
Area of 100-year coastal flood with velocity (open water), base flood elevations and flood hazard factors not determined.

VI-VI-20
Area of 100-year coastal flood with velocity (open water), base flood elevations and flood hazard factors determined.

NOTES TO USER

Certain areas not in the special flood hazard area (zones A and V) may be protected by flood control structures. This map is for flood insurance purposes only; it does not necessarily show all areas subject to flooding in the community or all properties having special flood hazard areas. For additional map panels, see separate printed maps to this map.

ISSUAL IDENTIFICATION:
NOVEMBER 26, 1984

FLOOD HAZARD BOUNDARY MAP REVISIONS:
NOVEMBER 26, 1984

FLOOD INSURANCE RATE MAP EFFECTIVE:
OCTOBER 15, 1981

FLOOD INSURANCE RATE MAP REVISIONS:
NOVEMBER 26, 1984

Refer to the FLOOD INSURANCE RATE MAP EFFECTIVE date shown on this map to determine when actual rates apply to structures in the areas where structures or depths have been established.

To determine if flood insurance is available in this community, contact your insurance agent, or call the National Flood Insurance Program, at (800) 678-6629.

2,000 ft

NATIONAL FLOOD INSURANCE PROGRAM

FIRM FLOOD INSURANCE RATE MAP

LEWIS COUNTY, WASHINGTON (UNINCORPORATED AREAS)

PANEL 460 OF 800
(SEE MAP INDEX FOR PANELS NOT PRINTED)

COMMUNITY-PANEL NUMBER
530102 0460 B

EFFECTIVE DATE:
DECEMBER 15, 1981

Federal Emergency Management Agency

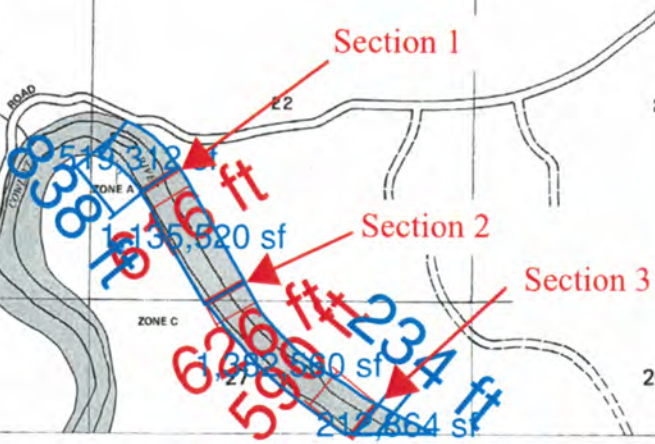

25

30

Cowlitz Timber Trails Association

Section locations, distances, floodplain widths and floodplain areas

Area A, upstream of Section 3



KEY TO MAP

100-Year Flood Boundary	Zone B
100-Year Flood Boundary	Zone B
Zone Outpath	Zone B
100-Year Flood Boundary	Zone B
300-Year Flood Boundary	Zone B
Base Flood Elevation Line With Elevation in Feet**	87.2
Base Flood Elevation in Feet Where Uniform Within Zone**	86.987
Elevation Reference Mark	RM7c
Zone D Boundary	
Key: Mile	1/8 MI

**Referenced to the National Geodetic Vertical Datum of 1929

***EXPLANATION OF ZONE DESIGNATIONS**

ZONE	EXPLANATION
A	Area of 100-year flood; base flood elevations and flood hazard factors not determined.
AD	Area of 100-year shallow flooding where depths are between one (1) and three (3) feet; average depths of inundation are shown, but no flood hazard factors are determined.
AH	Area of 100-year shallow flooding where depths are between one (1) and three (3) feet; base flood elevations are shown, but no flood hazard factors are determined.
A1-A20	Area of 100-year flood; base flood elevations and flood hazard factors determined.
AMB	Area of 100-year flood to be protected by flood protection system under construction; base flood elevations and flood hazard factors not determined.
B	Area between limits of the 100-year flood and 300-year flood; or certain areas subject to 100-year flooding with average depths less than one (1) foot or where the contributing drainage area is less than one square mile; or areas protected by levees from the base flood. (Minimum shading)
C	Area of minimal flooding. (No shading)
D	Area of undetermined, but possible, flood hazards.
V	Area of 100-year coastal flood with velocity (wave action); base flood elevations and flood hazard factors not determined.
V1-V20	Area of 100-year coastal flood with velocity (wave action); base flood elevations and flood hazard factors determined.

NOTES TO USER

Certain areas not in the special flood hazard areas (Zones A and V) may be protected by flood control structures.

This map is for flood insurance purposes only; it does not necessarily show all areas subject to flooding in the community or all planimetric features outside special flood hazard areas.

For obtaining map panels, see separately printed Index To Map Panels.

INITIAL IDENTIFICATION:
NOVEMBER 28, 1974

FLOOD HAZARD BOUNDARY MAP REVISIONS:
NOVEMBER 28, 1977

FLOOD INSURANCE RATE MAP EFFECTIVE:
DECEMBER 15, 1981

FLOOD INSURANCE RATE MAP REVISIONS:

Refer to the FLOOD INSURANCE RATE MAP EFFECTIVE date shown on this map to determine when actuarial rates apply to structures in the zones where elevations or depths have been established.

To determine if flood insurance is available in this community, contact your insurance agent, or call the National Flood Insurance Program, at (800) 638-6720.



NATIONAL FLOOD INSURANCE PROGRAM

FIRM
FLOOD INSURANCE RATE MAP

LEWIS COUNTY, WASHINGTON
(UNINCORPORATED AREAS)

PANEL 470 OF 800
(SEE MAP INDEX FOR PANELS NOT PRINTED)

COMMUNITY-PANEL NUMBER
530102 0470 B

EFFECTIVE DATE:
DECEMBER 15, 1981

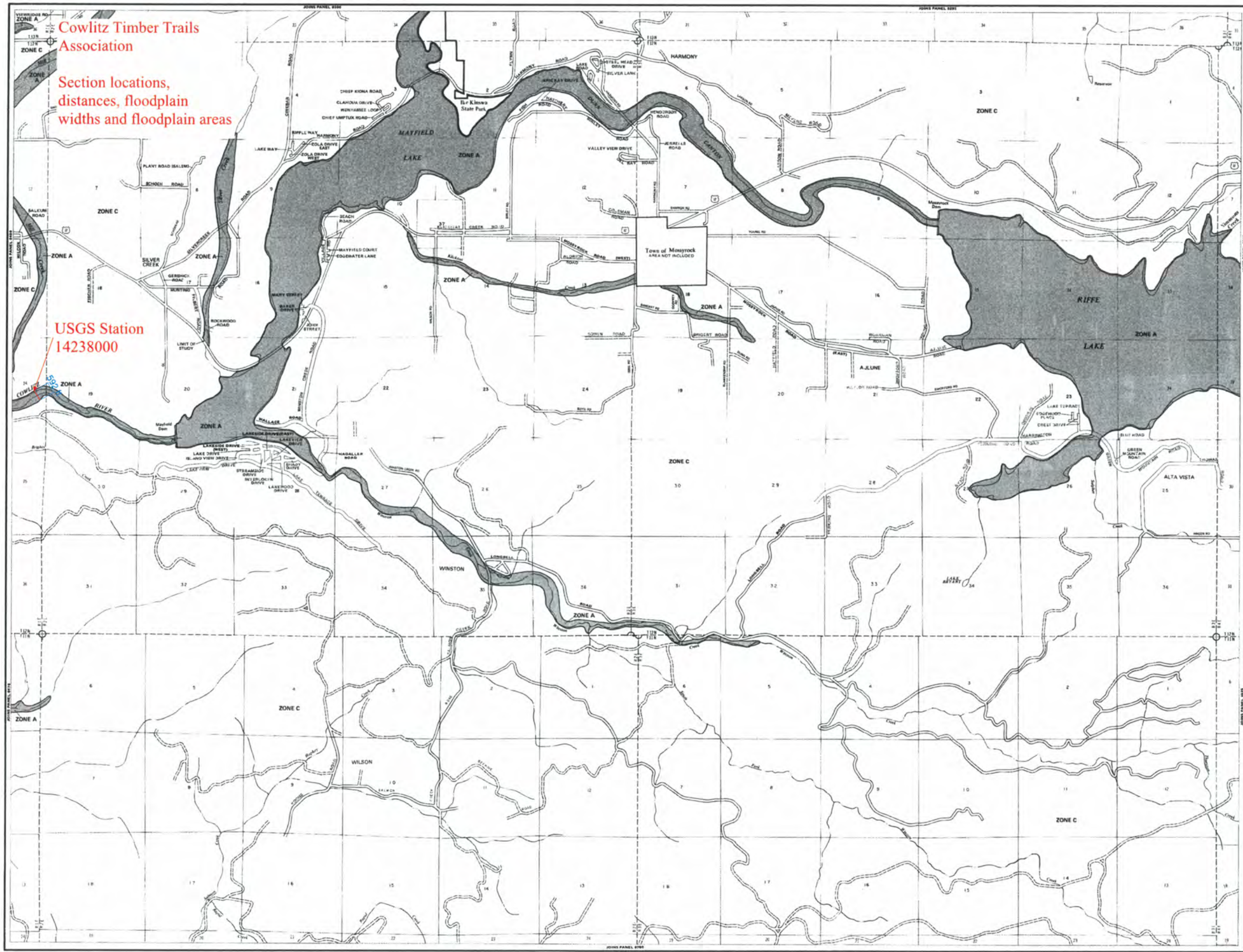

Cowlitz Timber Trails Association

Section locations, distances, floodplain widths and floodplain areas

USGS Station 14238000

KEY TO MAP

- 100-Year Flood Boundary
- 100-Year Flood Boundary
- Zone Designations
- 100-Year Flood Boundary
- 100-Year Flood Boundary
- Base Flood Elevation Line With Elevation in Feet
- Base Flood Elevation in Feet Where Location Within Zone
- Evolution Reference Mark
- Zone D Boundary
- River Mile

***Revised to the National Geodetic Vertical Datum of 1929

***EXPLANATION OF ZONE DESIGNATIONS**

ZONE

A Areas of 100-year flood; base flood elevations and flood hazard factors not determined.

AB Areas of 100-year shallow flooding, where depths are between one (1) and three (3) feet; base flood elevations are shown, but no flood hazard factors are determined.

ABH Areas of 100-year shallow flooding, where depths are between one (1) and three (3) feet; base flood elevations are shown, but no flood hazard factors are determined.

ABD Areas of 100-year flood to be protected by flood protection works, under investigation; base flood elevations and flood hazard factors not determined.

B Areas between limits of the 100-year flood and 100-year flood, on certain areas subject to 100-year flooding with average depths less than one (1) foot, or where the contributing drainage area is less than one square mile, or areas protected by levees from the base flood (structure shading).

C Areas of moderate flooding (two stories).

D Areas of unincorporated, but possible, flood hazards.

V Areas of 100-year coastal flood with velocity (wave action); base flood elevations and flood hazard factors not determined.

V1-V20 Areas of 100-year coastal flood with velocity (wave action); base flood elevations and flood hazard factors determined.

NOTES TO USER

Certain areas are in the special flood hazard area (Zone A and V) and may be protected by flood control structures. This map is for flood insurance purposes only; it does not necessarily show all areas subject to flooding in the community or all flood-related features including special flood hazard areas. For additional map panels, see separate print index to Map Panel.

INITIAL IDENTIFICATION:
NOVEMBER 28, 1974

FLOOD HAZARD BOUNDARY MAP REVISIONS:
NOVEMBER 28, 1977

FLOOD INSURANCE RATE MAP EFFECTIVE DATE:
DECEMBER 15, 1981

FLOOD INSURANCE RATE MAP REVISIONS:

Refer to the FLOOD INSURANCE RATE MAP EFFECTIVE DATE shown on this map to determine when actual rates apply to properties in the areas whose elevations or depths have been revised.

To determine if flood insurance is available in this community, contact your insurance agent, or call the National Flood Insurance Program, at (800) 638-6633.

4,000 ft
APPROXIMATE SCALE
0 4000 FEET

NATIONAL FLOOD INSURANCE PROGRAM

FIRM
FLOOD INSURANCE RATE MAP

LEWIS COUNTY, WASHINGTON
(UNINCORPORATED AREAS)

PANEL 500 OF 800
SEE MAP INDEX FOR PANELS NOT PRINTED

COMMUNITY-PANEL NUMBER
530102 0500 B

EFFECTIVE DATE:
DECEMBER 15, 1981

Federal Emergency Management Agency