

**BEFORE THE BOARD OF COUNTY COMMISSIONERS
LEWIS COUNTY, WASHINGTON**

IN THE MATTER OF:

RESOLUTION NO. 22-327

APPROVE THE DE-ANNEXATION OF A PORTION
OF CEMETERY DISTRICT 2

WHEREAS, Lewis County Cemetery District 2 stretches from Salkum to Riffe Lake;
and

WHEREAS, when the lake was formed, a patch of forestland in the district was
orphaned on its east side; and

WHEREAS, the orphaned patch is not well served by the district because it has
no residents; and

WHEREAS, the patch is in a tax code area in which the aggregate of all junior
taxing district levies is near the lawful limit as per RCW 84.52.043(2). If this limit
is reached, Cemetery District 2's levy will be reduced across the whole district
under a process called prorationing (RCW 84.52.010[3][b]); and

WHEREAS, Cemetery District 2 wishes to remove the orphaned patch to prevent
the prorationing process and has initiated the process by which it may withdraw
territory, as outlined in RCWs 68.54.130 and 57.28.035; and

WHEREAS, Cemetery District 2 wishes to de-annex 1,272.45 acres consisting of
10 parcels lying northeasterly of Riffe Lake that are currently within the service
boundary of the cemetery district; and

WHEREAS, Cemetery District 2 held a hearing regarding the proposed withdrawal
on August 4, 2022, and has provided to the Lewis County Board of County
Commissioners (BOCC) the following:

- A copy of its resolution regarding the withdrawal
- A copy of the legal notice for the Aug. 4, 2022, hearing
- A copy of the minutes for its Aug. 4, 2022, hearing
- A copy of the proposed legal boundaries

WHEREAS, it appears to be in the public's best interest to approve the de-
annexation.

NOW THEREFORE BE IT RESOLVED the Lewis County Board of County
Commissioners hereby approves Cemetery District 2's de-annexation of 1,272.45
acres as outlined in Exhibit A.

DONE IN OPEN SESSION this 11th day of October, 2022.

APPROVED AS TO FORM:
Jonathan Meyer, Prosecuting Attorney

BOARD OF COUNTY COMMISSIONERS
LEWIS COUNTY, WASHINGTON

Amber Smith
By: Amber Smith,
Deputy Prosecuting Attorney

Lindsey R. Pollock, DVM
Lindsey R. Pollock, DVM, Chair

ATTEST:

Sean D. Swope
Sean D. Swope, Vice Chair

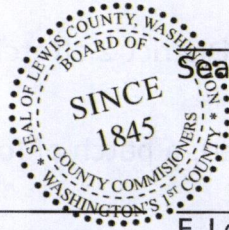

Rieva Lester
Rieva Lester,
Clerk of the Lewis County Board of
County Commissioners

F. Lee Grose
F. Lee Grose, Commissioner

RECEIVED 07/01/2022

22-312 Cemetery Dist. #2 6-24-2022

Description of Area to be Withdrawn From Lewis County Cemetery Dist. No. 2

All of Section 21, Township 12 North, Range 4 East, W.M., Lewis County, Washington.

Also that portion of Section 28, Township 12 North, Range 4 East, W.M., Lewis County, Washington, more particularly described as follows: Beginning at the Northeast Corner of the Northeast Quarter of said Section 28; thence S87°55'06"W along the north line of said Northeast Quarter a distance of 84.53 feet to the Southeast Corner of Section 21, said Township and Range; thence N87°55'32"W along the north line the Northeast Quarter of said Section 28 a distance of 2583.77 feet to the Northwest Corner of said subdivision; thence N88°45'16"W along the north line of the Northwest Quarter of said Section 28 a distance of 2655.01 feet to the Northwest Corner of said subdivision; thence S43°46'23"E a distance of 1889.97 feet to the Northwest Corner of the Southeast Quarter of the Northwest Quarter of said Section 28; thence S88°47'23"E along the north line of said subdivision a distance of 1325.90 feet to the Northwest Corner of the Southwest Quarter of the Northeast Quarter of said Section 28; thence S43°57'26"E a distance of 1892.58 feet to the Southeast Corner of said subdivision; thence S44°07'02"E a distance of 1867.32 feet to the Southeast Corner of the Southeast Quarter of said Section 28; thence N01°31'48"E along the east line of said Southeast Quarter a distance of 1313.68 feet to the Northeast Corner of said subdivision; thence N00°51'07"E along the east line of the Northeast Quarter of said Section 28 a distance of 2634.59 feet to the Point of Beginning.

Also that portion of Section 20, Township 12 North, Range 4 East, W.M., Lewis County, Washington, more particularly described as follows: Beginning at the Northeast Corner of said Section 20; thence West along the north line of the Northeast Quarter of said Section 20 a distance of 2640 feet more or less to the Northwest Corner of said subdivision; thence N89°13'57"W along the north line of the Northwest Quarter of said Section 20 a distance of 2641.50 feet to the Northwest Corner of said subdivision; thence S00°46'39"W along the west line of the Northwest Quarter of said Section 20 a distance of 659.48 feet to the northeasterly line of City of Tacoma project boundary; thence S44°20'06"E along said line a distance of 934.20 feet to the south line of the Northwest Quarter of the Northwest Quarter of said Section 20; thence S44°24'09"E along said line a distance of 935.18 feet to the west line of the Southeast Quarter of the Northwest Quarter of said Section 20; thence S44°28'16"E along said line a distance of 936.19 feet to the north line of the Northeast Quarter of the Southwest Quarter of said Section 20; thence S44°55'18"E along said line a distance of 931.02 feet to the east line

of said subdivision; thence S21°39'46"E along said line a distance of 1742.08 feet to the north line of the south 350.00 feet of the South Half of the Southeast Quarter of said Section 20; thence S88°28'26"E along said north line a distance of 1973.40 feet to the east line of said subdivision; thence N00°01'30"W along the east line of the Southeast Quarter of said Section 20 a distance of 2287.82 feet to the Northeast Corner of said subdivision; thence North along the east line of the Northeast Quarter of said Section 20 a distance of 2640 feet more or less to the Northeast Corner of said Section 20 and the Point of Beginning.

Also that portion of the Northeast Quarter of the Northeast Quarter of Section 19, Township 12 North, Range 4 East, W.M., Lewis County, Washington, more particularly described as follows: Beginning at the Northeast Corner of said subdivision; thence N89°19'42"W along the north line of said subdivision a distance of 653.45 feet; thence S44°00'43"E a distance of 927.54 feet to the east line of said subdivision; thence N00°46'39"E along the east line of said subdivision a distance of 659.48 feet to the Point of Beginning.



Exhibit B Cemetery District #2 - Proposed Area to be Withdrawn

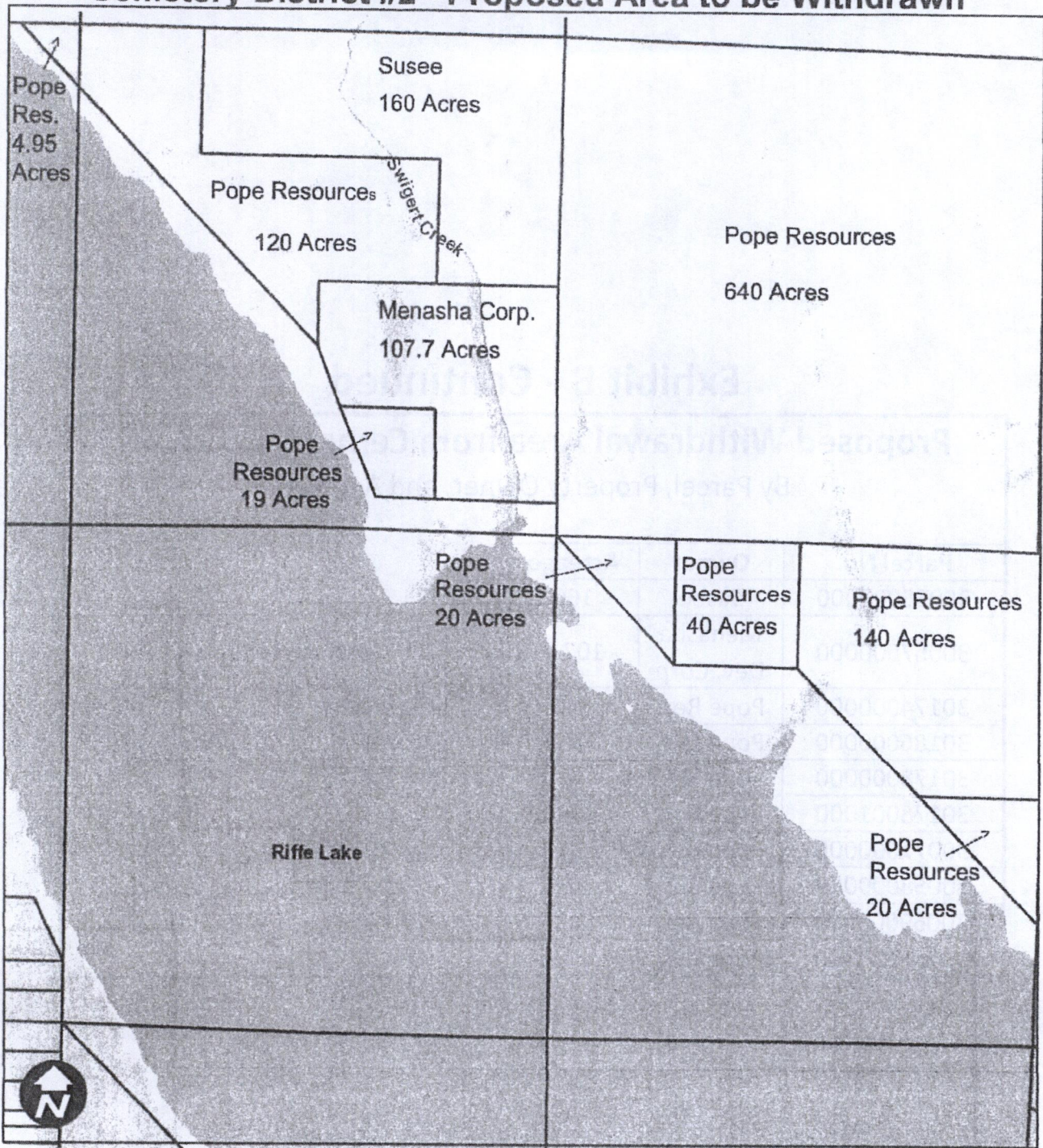

10/15/2019, 8:06:19 AM

1:18,056

 Parcels

0 800 1,600 3,200 ft
NAD 1983 StatePlane Washington South FPS 4602 Feet

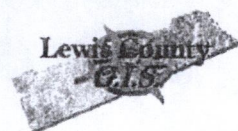

Data and Graphics derived from the Lewis County GIS Webmap. Ownership and acreage information is from tax assessment records, and so may not be completely accurate for this use. However, it is likely that the data is accurate enough to give a general sense of the area proposed for removal and its owners and acreages.

Exhibit B - Continued

Proposed Withdrawal Area from Cemetery Dist. #2

By Parcel, Property Owner, and Acreage

Parcel No.	Owner	Acreage
30055000000	Susee	160
30067000000	Menasha Dev. Corp	107.7
30174000000	Pope Res.	140
30186000000	Pope Res.	20
30178000000	Pope Res.	40
30178001000	Pope Res.	20
30071000000	Pope Res.	640.8
30058000000	Pope Res.	120
30069000000	Pope Res.	19
30034000000	Pope Res.	4.95

Total Acreage		%
All Owners	1272.45	100%
Pope Res.	1004.75	79.0%

Exhibit A

Cemetery District #2

NOI - EXHIBIT C

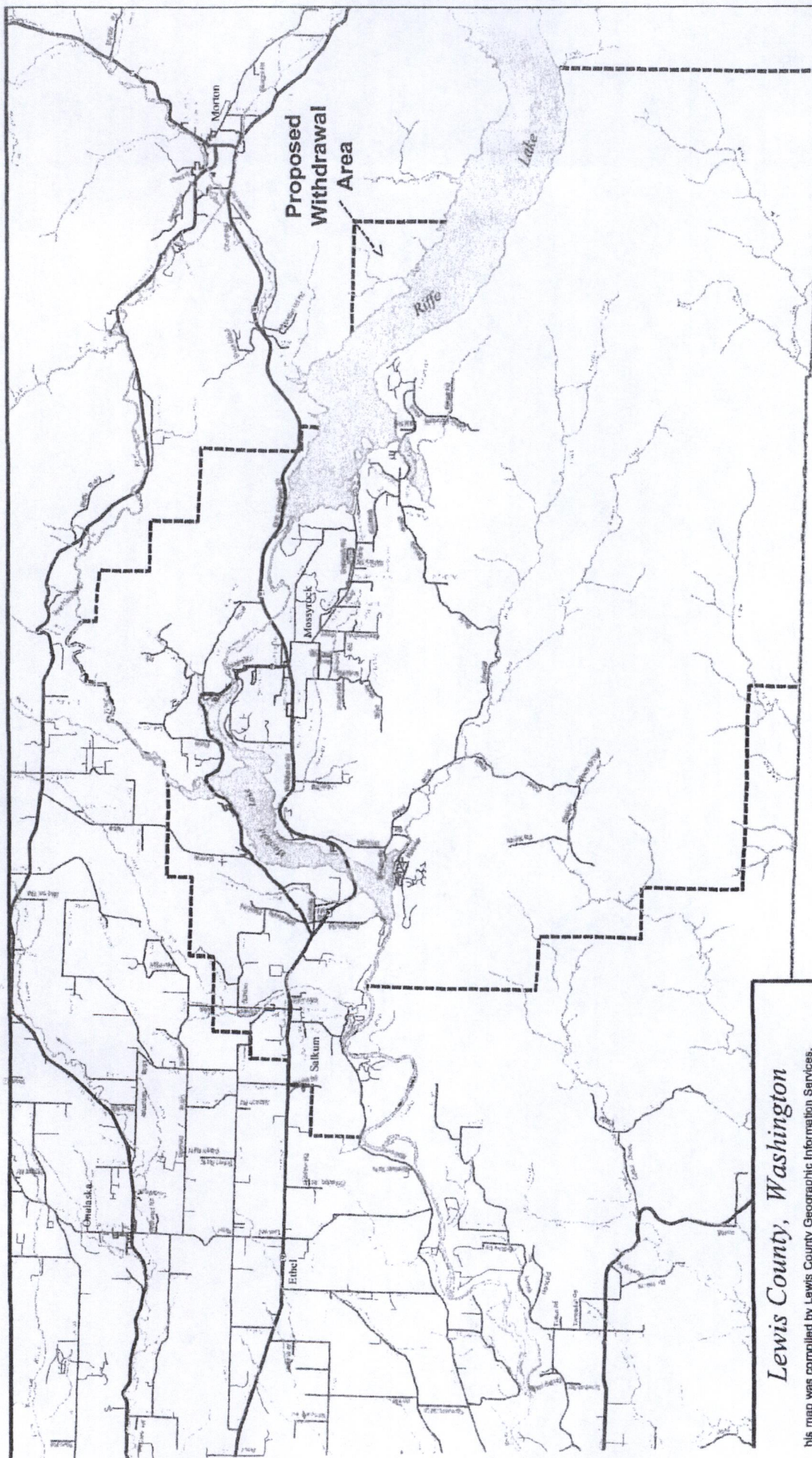
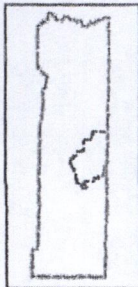

Lewis County, Washington

This map was compiled by Lewis County Geographic Information Services. The base map was developed by the Washington State Department of Natural Resources by scanning and digitizing United States Geological Survey 1:24,000 quadrangle maps. The accuracy of the map has not been verified, and it should be used for informational purposes only. Any possible discrepancies should be brought to the attention of Lewis County GIS.

Projection: Lambert Conformal Conic
Datum: 1983 North American Datum
S.G.S. State Plane Zone 5026

May 2011



BOCC AGENDA ITEM SUMMARY

Resolution: 22-327

BOCC Meeting Date: Oct. 11, 2022

Suggested Wording for Agenda Item:

Agenda Type: Hearing - Resolution

Approve the de-annexation of a portion of Cemetery District 2

Contact: Rieva Lester

Phone: 360-740-1419

Department: BOCC - Board of County Commissioners

Description:

Approve Cemetery District 2's de-annexation request

Approvals:

User	Status
PA's Office	Pending

Publication Requirements:

Publications:

Additional Copies:

Karen Witherspoon (BRB)

Cover Letter To:

Melanie Clowe, Cemetery District 2:
lewiscountycemetery2@gmail.com