

Lot Closures - Prepared using Survey/Civil Solutions for AutoCAD

Bearing Mode

Date Prepared: 3/12/2024

Drawing: merritt plat.dwg

Measurement Units: feet

RECEIVED

By Mollie Hurt at 1:10 pm, Mar 26, 2024

RIVERSIDE

Lot 1

Bearing	Distance	Northing/Lat	Easting/Dep
	54353.8880	49050.9682	Start (POB)
N 66°46'46" E	321.97	126.9436	295.8885
	54480.8316	49346.8567	
S 50°56'55" E	67.31	-42.4065	52.2716
	54438.4251	49399.1283	
S 39°03'05" W	285.00	-221.3254	-179.5551
	54217.0997	49219.5732	
N 50°56'55" W	217.12	136.7895	-168.6112
	54353.8892	49050.9620	
Closure in Lat/Dep:		-0.0012	0.0062

Starting Point: 54353.8880 49050.9682

Distance Error: S 79°02'46" E 0.0063

Total Distance: 891.40

Accuracy Ratio: 1:141,154

Area: 40,531 ft2 0.93 Acres

□

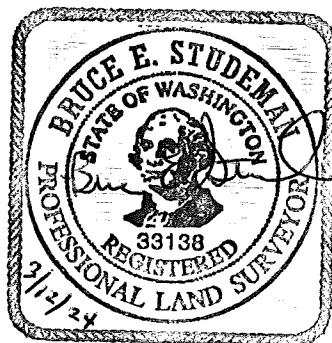

Lot Closures - Prepared using Survey/Civil Solutions for AutoCAD

Bearing Mode

Date Prepared: 3/12/2024

Drawing: merritt plat.dwg

Measurement Units: feet

RIVERSIDE

Lot 2

Bearing	Distance	Northing/Lat	Easting/Dep
	54438.4267	49399.1310	Start (POB)
S 50°56'55" E	125.00	-78.7522	97.0726
	54359.6745	49496.2036	
S 39°03'05" W	300.00	-232.9742	-189.0055
	54126.7003	49307.1981	
N 50°56'55" W	125.00	78.7523	-97.0725
	54205.4526	49210.1256	
N 39°03'05" E	300.00	232.9741	189.0054
	54438.4267	49399.1310	
Closure in Lat/Dep:		0.0000	0.0000

Starting Point: 54438.4267 49399.1310

Area: 37,500 ft2 0.86 Acres

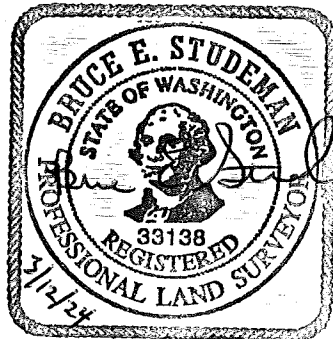

Lot Closures - Prepared using Survey/Civil Solutions for AutoCAD
 Bearing Mode
 Date Prepared: 3/12/2024
 Drawing: merritt plat.dwg
 Measurement Units: feet

 RIVERSIDE

Lot 3

Bearing	Distance	Northing/Lat	Easting/Dep
		53913.7853	50045.8208 Start (POB)
S 46°07'10" W	11.14	-7.7217	-8.0295
		53906.0636	50037.7913
S 20°47'46" W	4.63	-4.3284	-1.6439
		53901.7352	50036.1474
S 53°41'03" W	7.70	-4.5602	-6.2044
		53897.1750	50029.9430
S 58°45'59" W	19.71	-10.2202	-16.8532
		53886.9548	50013.0898
S 45°27'05" W	17.78	-12.4729	-12.6710
		53874.4819	50000.4188
S 29°27'38" W	5.95	-5.1807	-2.9264
		53869.3012	49997.4924
S 57°51'41" W	10.67	-5.6761	-9.0349
		53863.6251	49988.4575
S 38°29'02" W	12.46	-9.7535	-7.7538
		53853.8716	49980.7037
S 51°21'37" W	25.72	-16.0601	-20.0896
		53837.8115	49960.6141
S 35°19'01" W	9.01	-7.3518	-5.2087
		53830.4597	49955.4054

 ** Horizontal Curve:

S 65°22'36" W	9.71	-4.0457	-8.8270 Chord pc-pt
		53826.4140	49946.5784 pt
		53830.4597	49955.4054 pc
S 22°46'36" E	150.60	-138.8563	58.3034 Radial In pc-rp
		53691.6034	50013.7088 rp
Delta: 3°41'35"			
Radius: 150.60			
Length: 9.71			
Tangent: 4.86			
N 26°28'12" W	150.60	134.8106	-67.1304 Radial Out rp-pt
		53826.4140	49946.5784 pt

 ** Horizontal Curve:

S 42°42'29" W	4.60	-3.3802	-3.1200 Chord pc-pt
		53823.0338	49943.4584 pt
		53826.4140	49946.5784 pc
S 26°28'12" E	6.47	-5.7917	2.8838 Radial In pc-rp
		53820.6223	49949.4622 rp
Delta: 41°38'39"			

Radius: 6.47
Length: 4.71
Tangent: 2.46
N 68°06'50" W

6.47 2.4115 -6.0038 Radial Out rp-pt
53823.0338 49943.4584 pt

S 21°53'10" W

8.29 -7.6925 -3.0902
53815.3413 49940.3682

S 54°12'38" W

18.33 -10.7195 -14.8688
53804.6218 49925.4994

S 46°11'12" W

10.72 -7.4216 -7.7355
53797.2002 49917.7639

S 39°03'05" W

13.05 -10.1344 -8.2218
53787.0658 49909.5421

S 52°09'44" W

27.71 -16.9981 -21.8840
53770.0677 49887.6581

S 38°07'36" W

6.09 -4.7907 -3.7599
53765.2770 49883.8982

S 45°25'13" W

16.14 -11.3286 -11.4962
53753.9484 49872.4020

S 33°23'58" W

6.36 -5.3097 -3.5010
53748.6387 49868.9010

S 05°00'40" E

8.80 -8.7664 0.7687
53739.8723 49869.6697

S 34°08'45" W

6.91 -5.7188 -3.8786
53734.1535 49865.7911

S 06°57'44" W

11.17 -11.0876 -1.3540
53723.0659 49864.4371

** Horizontal Curve:

S 31°05'40" W

3.64 -3.1170 -1.8799 Chord pc-pt
53719.9489 49862.5572 pt
53723.0659 49864.4371 pc

N 85°27'07" W

4.07 0.3228 -4.0572 Radial In pc-rp
53723.3887 49860.3799 rp

Delta: 53°05'33"

Radius: 4.07

Length: 3.77

Tangent: 2.03

S 32°21'33" E

4.07 -3.4398 2.1773 Radial Out rp-pt
53719.9489 49862.5572 pt

S 57°38'27" W

12.84 -6.8723 -10.8460
53713.0766 49851.7112

S 61°02'59" W

11.73 -5.6779 -10.2642
53707.3987 49841.4470

S 33°50'29" W

13.35 -11.0883 -7.4346
53696.3104 49834.0124

S 56°34'22" W

8.03 -4.4236 -6.7017
53691.8868 49827.3107

S 40°20'43" W

4.70 -3.5821 -3.0427
53688.3047 49824.2680

S 09°58'35" W

9.20 -9.0609 -1.5938
53679.2438 49822.6742

S 23°43'05" W

12.19 -11.1604 -4.9033
53668.0834 49817.7709

S 17°42'59" W

4.89 -4.6581 -1.4880

	53663.4253	49816.2829	
S 07°13'53" E	7.78	-7.7181	0.9793
	53655.7072	49817.2622	
S 26°14'22" W	5.53	-4.9601	-2.4450
	53650.7471	49814.8172	
S 13°12'49" W	9.13	-8.8883	-2.0869
	53641.8588	49812.7303	

 ** Horizontal Curve:

S 21°31'16" W	17.64	-16.4102	-6.4712	Chord pc-pt
	53625.4486	49806.2591		pt
	53641.8588	49812.7303		pc
S 66°07'35" E	214.83	-86.9457	196.4494	Radial In pc-rp
	53554.9131	50009.1797		rp

Delta: 4°42'17"
 Radius: 214.83
 Length: 17.64
 Tangent: 8.82

N 70°49'52" W	214.83	70.5355	-202.9206	Radial Out rp-pt
	53625.4486	49806.2591		pt

 ** Horizontal Curve:

S 07°36'32" E	2.82	-2.7952	0.3734	Chord pc-pt
	53622.6534	49806.6325		pt
	53625.4486	49806.2591		pc
S 70°49'52" E	3.13	-1.0277	2.9565	Radial In pc-rp
	53624.4209	49809.2156		rp

Delta: 53°33'21"
 Radius: 3.13
 Length: 2.93
 Tangent: 1.58

S 55°36'47" W	3.13	-1.7675	-2.5831	Radial Out rp-pt
	53622.6534	49806.6325		pt

S 34°23'13" E	4.99	-4.1179	2.8183
	53618.5355	49809.4508	

 ** Horizontal Curve:

S 16°09'11" E	3.67	-3.5251	1.0210	Chord pc-pt
	53615.0104	49810.4718		pt
	53618.5355	49809.4508		pc
S 47°12'59" W	4.10	-2.7849	-3.0091	Radial In pc-rp
	53615.7506	49806.4417		rp

Delta: 53°15'41"
 Radius: 4.10
 Length: 3.81
 Tangent: 2.06

S 79°31'21" E	4.10	-0.7402	4.0301	Radial Out rp-pt
	53615.0104	49810.4718		pt

 ** Horizontal Curve:

S 20°13'37" W	18.01	-16.8994	-6.2268	Chord pc-pt
	53598.1110	49804.2450		pt
	53615.0104	49810.4718		pc
N 77°12'40" W	69.55	15.3954	-67.8247	Radial In pc-rp

53630.4058 49742.6471 rp

Delta: 14°52'35"

Radius: 69.55

Length: 18.06

Tangent: 9.08

S 62°20'05" E 69.55 -32.2948 61.5979 Radial Out rp-pt
53598.1110 49804.2450 pt

** Horizontal Curve:

S 24°12'54" W 28.42 -25.9194 -11.6568 Chord pc-pt
53572.1916 49792.5882 pt
53598.1110 49804.2450 pc

S 56°08'28" E 84.83 -47.2630 70.4438 Radial In pc-rp
53550.8480 49874.6888 rp

Delta: 19°17'16"

Radius: 84.83

Length: 28.56

Tangent: 14.42

N 75°25'44" W 84.83 21.3436 -82.1006 Radial Out rp-pt
53572.1916 49792.5882 pt

S 14°44'07" W 8.10 -7.8336 -2.0603
53564.3580 49790.5279

N 89°31'55" W 188.89 1.5433 -188.8837
53565.9013 49601.6442

N 50°56'55" W 62.89 39.6218 -48.8391
53605.5231 49552.8051

N 09°03'05" E 288.68 285.0852 45.4155
53890.6083 49598.2206

N 50°56'55" W 374.76 236.1056 -291.0313
54126.7139 49307.1893

N 39°03'05" E 300.00 232.9742 189.0055
54359.6881 49496.1948

S 50°56'55" E 707.74 -445.8890 549.6170
53913.7991 50045.8118

Closure in Lat/Dep: -0.0138 0.0090

Starting Point: 53913.7853 50045.8208

Distance Error: S 33°06'41" E 0.0165

Total Distance: 2382.94

Accuracy Ratio: 1:144,636

Area: 264,800 ft² 6.08 Acres

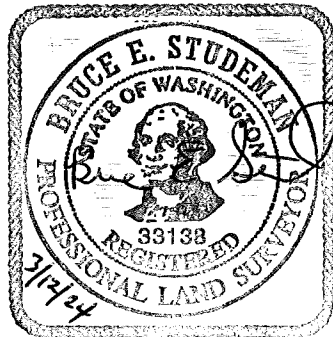

Lot Closures - Prepared using Survey/Civil Solutions for AutoCAD
Bearing Mode
Date Prepared: 3/12/2024
Drawing: merritt plat.dwg
Measurement Units: feet

RIVERSIDE

Lot 4

Bearing	Distance	Northing/Lat	Easting/Dep
	54077.4594	48971.0801	Start (POB)
N 50°56'55" W	245.69	154.7891	-190.7981
	54232.2485	48780.2820	
N 65°43'20" E	274.48	112.8555	250.2058
	54345.1040	49030.4878	
N 66°46'46" E	22.28	8.7843	20.4752
	54353.8883	49050.9630	
S 50°56'55" E	217.12	-136.7895	168.6111
	54217.0988	49219.5741	
S 39°03'05" W	30.00	-23.2974	-18.9005
	54193.8014	49200.6736	
N 50°56'55" W	105.00	66.1519	-81.5410
	54259.9533	49119.1326	
S 39°03'05" W	235.00	-182.4964	-148.0542
	54077.4569	48971.0784	
Closure in Lat/Dep:		0.0025	0.0017

Starting Point: 54077.4594 48971.0801

Distance Error: N 34°12'57" E 0.0030
Total Distance: 1129.57
Accuracy Ratio: 1:373,627
Area: 50,615 ft2 1.16 Acres

□

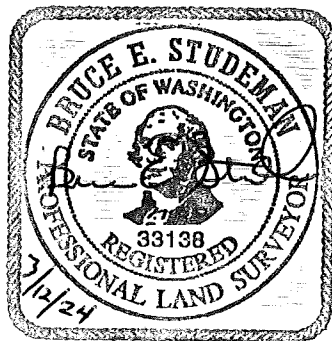

Lot Closures - Prepared using Survey/Civil Solutions for AutoCAD

Bearing Mode

Date Prepared: 3/12/2024

Drawing: merritt plat.dwg

Measurement Units: feet

RIVERSIDE

Lot 5

Bearing	Distance	Northing/Lat	Easting/Dep
		54011.3075	49052.6211 Start (POB)
N 50°56'55" W	105.00	66.1519	-81.5410
		54077.4594	48971.0801
N 39°03'05" E	235.00	182.4964	148.0542
		54259.9558	49119.1343
S 50°56'55" E	105.00	-66.1519	81.5410
		54193.8039	49200.6753
S 39°03'05" W	235.00	-182.4964	-148.0542
		54011.3075	49052.6211
Closure in Lat/Dep:		0.0000	0.0000

Starting Point: 54011.3075 49052.6211

Area: 24,675 ft2 0.57 Acres

□

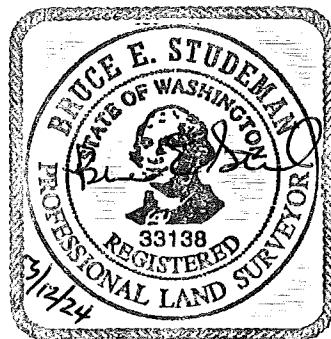

Lot Closures - Prepared using Survey/Civil Solutions for AutoCAD

Bearing Mode

Date Prepared: 3/12/2024

Drawing: merritt plat.dwg

Measurement Units: feet

RIVERSIDE

Lot 6

Bearing	Distance	Northing/Lat	Easting/Dep
	53938.8554	49141.9278	Start (POB)
N 50°56'55" W	115.00	72.4521	-89.3067
	54011.3075	49052.6211	
N 39°03'05" E	250.00	194.1451	157.5045
	54205.4526	49210.1256	
S 50°56'55" E	115.00	-72.4521	89.3067
	54133.0005	49299.4323	
S 39°03'05" W	250.00	-194.1451	-157.5045
	53938.8554	49141.9278	
Closure in Lat/Dep:		0.0000	0.0000

Starting Point: 53938.8554 49141.9278

Area: 28,750 ft2 0.66 Acres

□



Lot Closures - Prepared using Survey/Civil Solutions for AutoCAD
Bearing Mode
Date Prepared: 3/12/2024
Drawing: merritt plat.dwg
Measurement Units: feet

RIVERSIDE

Lot 7

Bearing	Distance	Northing/Lat	Easting/Dep
	53872.7035	49223.4688	Start (POB)
N 50°56'55" W	105.00	66.1519	-81.5410
	53938.8554	49141.9278	
N 39°03'05" E	250.00	194.1451	157.5045
	54133.0005	49299.4323	
S 50°56'55" E	105.00	-66.1519	81.5410
	54066.8486	49380.9733	
S 39°03'05" W	250.00	-194.1451	-157.5045
	53872.7035	49223.4688	
Closure in Lat/Dep:		0.0000	0.0000

Starting Point: 53872.7035 49223.4688

Area: 26,250 ft2 0.60 Acres

□

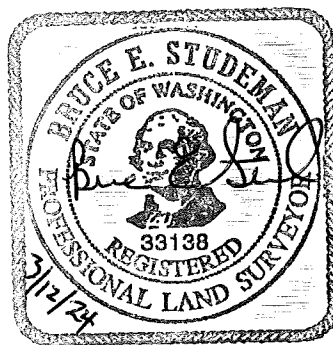

Lot Closures - Prepared using Survey/Civil Solutions for AutoCAD

Bearing Mode

Date Prepared: 3/12/2024

Drawing: merritt plat.dwg

Measurement Units: feet

RIVERSIDE

Lot 8

Bearing	Distance	Northing/Lat	Easting/Dep
	53806.5516	49305.0097	Start (POB)
N 50°56'55" W	105.00	66.1519	-81.5409
	53872.7035	49223.4688	
N 39°03'05" E	250.00	194.1451	157.5045
	54066.8486	49380.9733	
S 50°56'55" E	105.00	-66.1519	81.5409
	54000.6967	49462.5142	
S 39°03'05" W	250.00	-194.1451	-157.5045
	53806.5516	49305.0097	
Closure in Lat/Dep:		0.0000	0.0000

Starting Point: 53806.5516 49305.0097

Area: 26,250 ft2 0.60 Acres

□

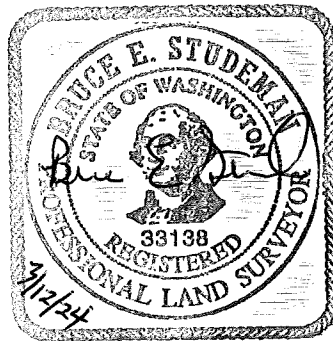

Lot Closures - Prepared using Survey/Civil Solutions for AutoCAD
Bearing Mode
Date Prepared: 3/12/2024
Drawing: merritt plat.dwg
Measurement Units: feet

RIVERSIDE

Lot 9

Bearing	Distance	Northing/Lat	Easting/Dep
	53605.5161	49552.8125	Start (POB)
N 50°56'55" W	319.09	201.0325	-247.7991
	53806.5486	49305.0134	
N 39°03'05" E	250.00	194.1451	157.5045
	54000.6937	49462.5179	
S 50°56'55" E	174.76	-110.1019	135.7152
	53890.5918	49598.2331	
S 09°03'05" W	288.68	-285.0852	-45.4155
	53605.5066	49552.8176	
Closure in Lat/Dep:		0.0095	-0.0051

Starting Point: 53605.5161 49552.8125

Distance Error: N 28°13'43" W 0.0108
Total Distance: 1032.53
Accuracy Ratio: 1:95,760
Area: 61,731 ft2 1.42 Acres

□

